

SERIES 1B

ELECTRICAL FUNCTIONS

DIMENSIONS

SPDT			
1	on	none	on
2	on	none	(on)
3	on	off	on
4	(on)	off	(on)
5	on	off	(on)
	2 - 3	open	2 - 1

2 Comm.
 1 3 •

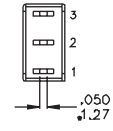
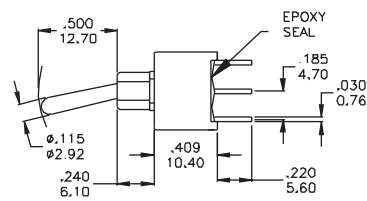
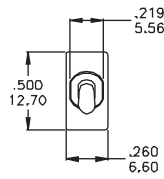

Part N° shown: 1B11-NF4PCAE

DPDT			
1	on	none	on
2	on	none	(on)
3	on	off	on
4	(on)	off	(on)
5	on	off	(on)
6 (*)	on	on	on
7 (*)	(on)	on	(on)
8 (*)	on	on	(on)
	2-3, 5-6	open	2-1,5-4

2 Comm. 5 Comm.
 1 3 • 4 6 •

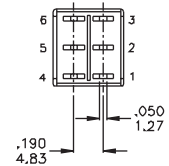
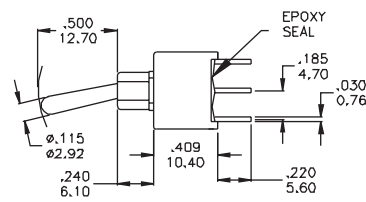
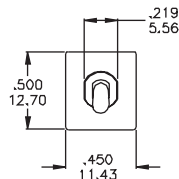

Part N° shown: 1B21-NF4PCAE

3PDT			
1	on	none	on
2	on	none	(on)
3	on	off	on
4	(on)	off	(on)
5	on	off	(on)
	2-3, 5-6	open	2-1,5-4

2 Comm. 5 Comm. 8 Comm.
 1 3 • 4 6 • 7 9 •

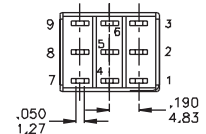
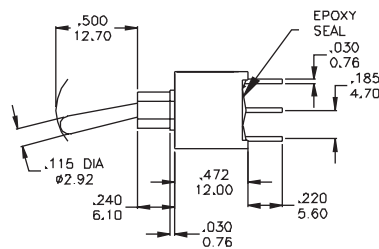
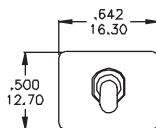

Part N° shown: 1B31-NF4PCAE

(*) See wiring for 3-Way Switching Functions pag. iii in the Technical Notations section

ACTUATORS

Standard when ordered with ST, PC terminations

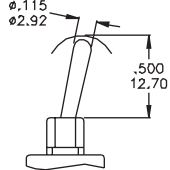

Subtract 2.68 for F1 bushing

N

Standard when ordered with H9, V9, U2 terminations

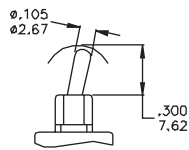

Subtract 2.68 for F1 bushing

N2

Antistatic Plastic Black Toggle

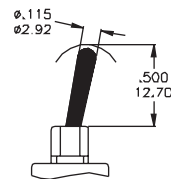

ES

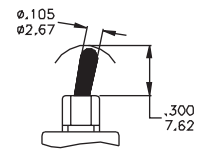

ES4

Note: Static resistance 9000 VDC, between actuator and terminals. Not available with E1 conductive bushing

BUSHING

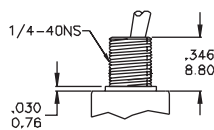

F1

Standard with PC, H9, V9, U terminations

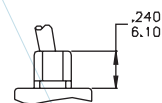

F4



SERIES 1B

TERMINATIONS

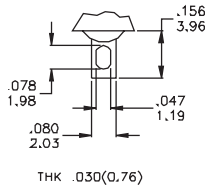

ST

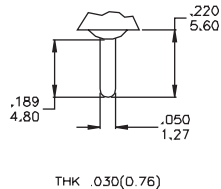

PC

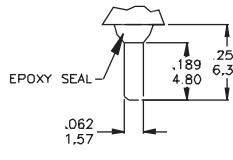

QC

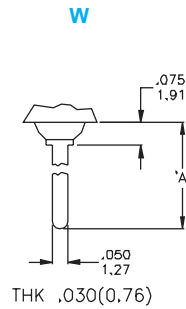

W

Dim. A	
W1	.750 (19.05)
W2	.964 (24.48)
W3	.425 (10.80)
W4	1.062 (26.97)

H9 SPDT

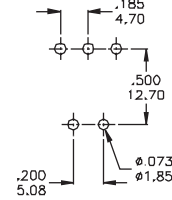
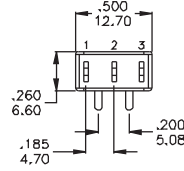
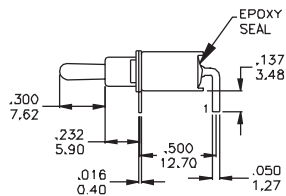
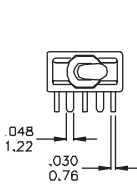

Part N° shown: 1B11-N2F4H9AE

H9 DPDT

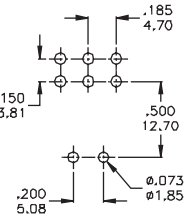
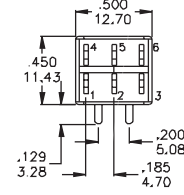
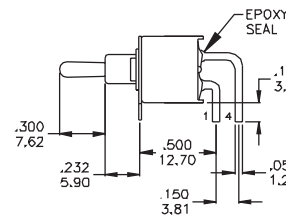
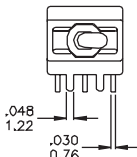

Part N° shown: 1B21-N2F4H9AE

V9 SPDT

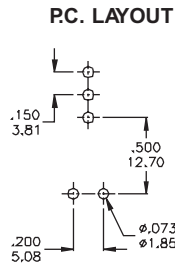
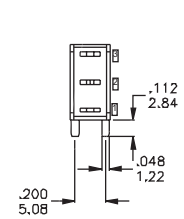
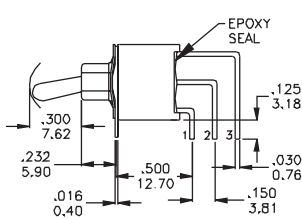
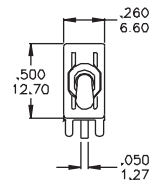

Part N° shown: 1B11-N2F4V9AE

V9 DPDT

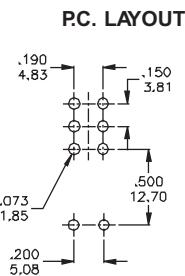
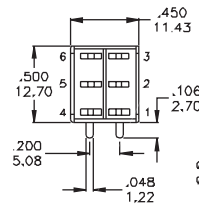
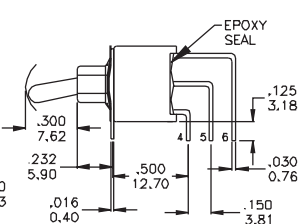
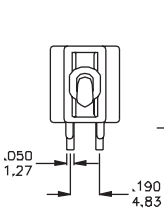

Part N° shown: 1B21-N2F4V9AE

SERIES 1B

TERMINATIONS

V9
3PDT

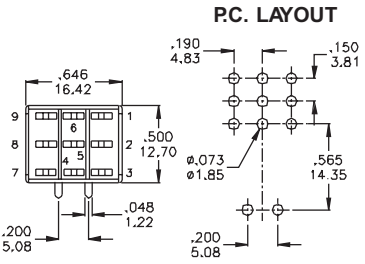
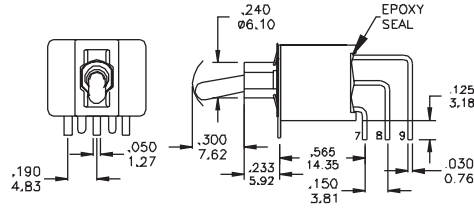

Part N° shown: 1B31-N2F4V9AE

U2 U3
SPDT

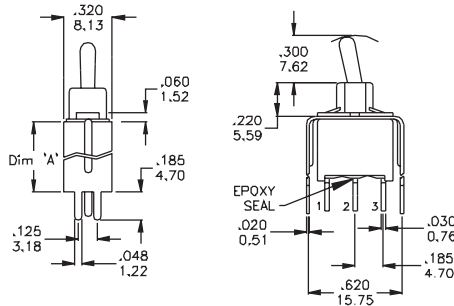

Dim. A	
U2	.460 (11.68)
U3	.630 (16.00)

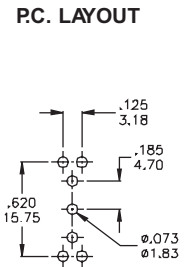

Part N° shown: 1B11-N2F4U_AE

U4 U5
SPDT

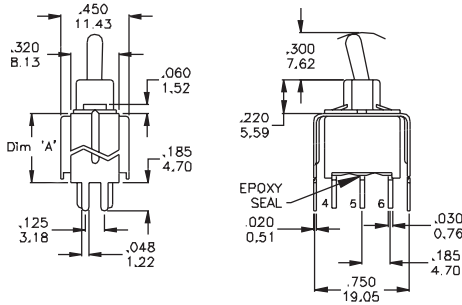

Dim. A	
U4	.460 (11.68)
U5	.630 (16.00)

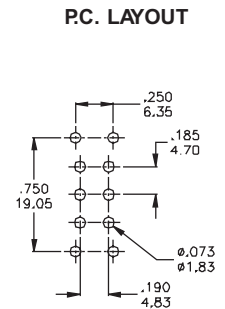

Part N° shown: 1B11-N2F4U_AE



SERIES 1B

TERMINATIONS

**U4 U5
3PDT**

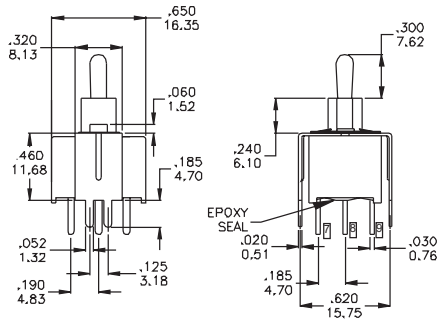

Dim. A	
U4	.460 (11.68)
U5	.630 (16.00)

PC. LAYOUT

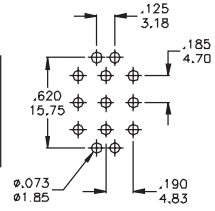

Part N° shown: 1B31-N2F4U_AE

Snap-in termination options

H9S

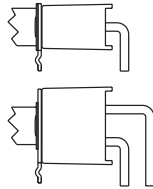
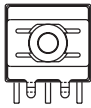

**U2S
U3S**

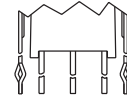

V9S

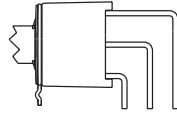
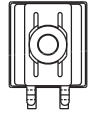

**U4S
U5S**

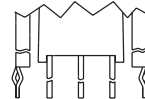

H9S, V9S, U2S, U3S, U4S, U5S have the same PC layout but are supplied with snap-in bracket to grip onto the PCB

SERIES 1B

CONTACT MATERIALS

CONTACT RATINGS

- S (std) Moving Contacts:** coin silver
Terminals: copper alloy, silver plated
Rating: 2 Amps with resistive load @ 250 VAC
 5 Amps with resistive load @ 125 VAC or 28 VDC
- A Moving Contacts:** copper alloy with gold plating over nickel plating
Terminals: copper alloy with gold plating over nickel plating
Rating: 0.4 Volts/Amps max @ 20 Volts max (AC or DC)
- G Moving Contacts:** gold plating over silver
End Terminals: gold plating over silver
Center Terminals: gold plating over copper alloy, silver plated
Note: G option used for either "high" (2 Amps @ 250 VAC) or "low" (0.4 Volts/Amps max) contact rating (one exclude the other)

PACKAGING

MARKING
(on products)LABELLING
(on packaging)

Transparent Trays 15x21x4 cm



Qty per tray: (ST, PC Terminals)
 Series 1B1x 200 pcs
 1B2x 100 pcs
 1B3x 100 pcs



The switches are individually marked with the following information:

Side 1 TRADE MARK
 SERIES AND MODEL
 DATE CODE

Side 2 RATING
 CONTACTS

Note: Not all information may be available on some products.

The label on each tray gives full information on the products contained.

P/N: EL.FNC.: Q.TY: DATE CODE:  Made in Taiwan	
Remarks	

A Bar code indicating Model, Quantity, Date Code enables easy traceability.