

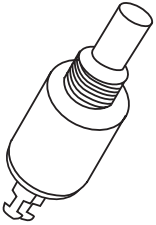

## SERIES 6R

- Subminiature Reset Push Button



## CHARACTERISTICS

- Over travel
- Normally open contact
- Extremely miniaturized

## SPECIFICATIONS

**Contact Rating:** Gold plated over nickel plated - 0.4 VA max @ 20 VAC or DC max

**Contact Resistance:** 30 mΩ max. initial @ 2-4 VDC - 10 mA, for both silver and gold plated contacts

**Insulation Resistance:** 109 MΩ

**Dielectric Strength:** 500 VRMS @ sea level

**Operating Temperature:** -30°C to 65°C

## MATERIALS

**Case :** Dialyphthalate (DAP) UL94V-0 metal container

**Plunger:** Glass filled nylon(UL94V-0)

**Contacts:** Copper alloy with gold over nickel plated

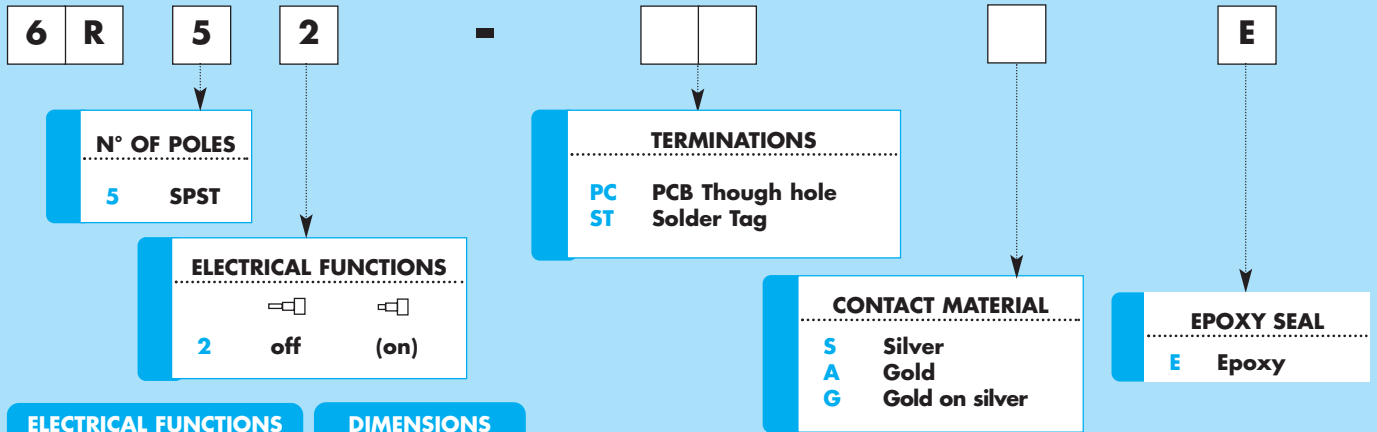

## ELECTRICAL FUNCTIONS

## DIMENSIONS

Model No.	Contact Position	Type	Schematic
6R52-	NO	off (on)	

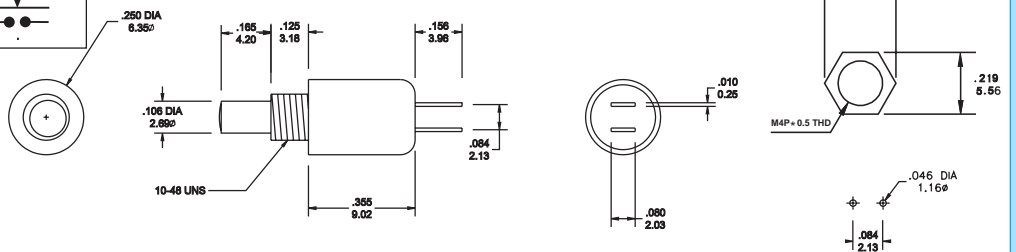

## TERMINATIONS

