

SERIES DRG3-4,DRGM

- Rotary sealed DIL encoders
- 10mm x 10mm

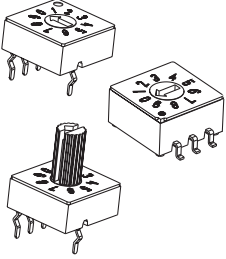

CHARACTERISTICS

- Molded-in terminals
- Fully sealed construction
- UL94V-0 Materials
- Binary Decimal and Hexadecimal codes
- Pin-out compatible with most current equivalents
- Gold plated contacts

SPECIFICATIONS

Rating: Switching 25mA, 24 @ VDC
non Switching 100 mA@ 50 VDC
Contact Resistance: 100 m Ω max
Insulation Resistance: 1000 Ω @100VDC
Dielectric Strength: 250 VDC, 1 Min
Temperature: Operating -25°C to +70°C
Storage -40°C to +85°C
Life: 20000 Operations
Operating Force: 500 Gr/cm Max
Vibration: per Mil - STD-202F, method 204D
Solderability: After flux 230 ±5°C for 5 ±0.5 secs 95% coverage
Soldering Heat: 260 ±5°C for 5 ±1 secs.

HOW TO ORDER

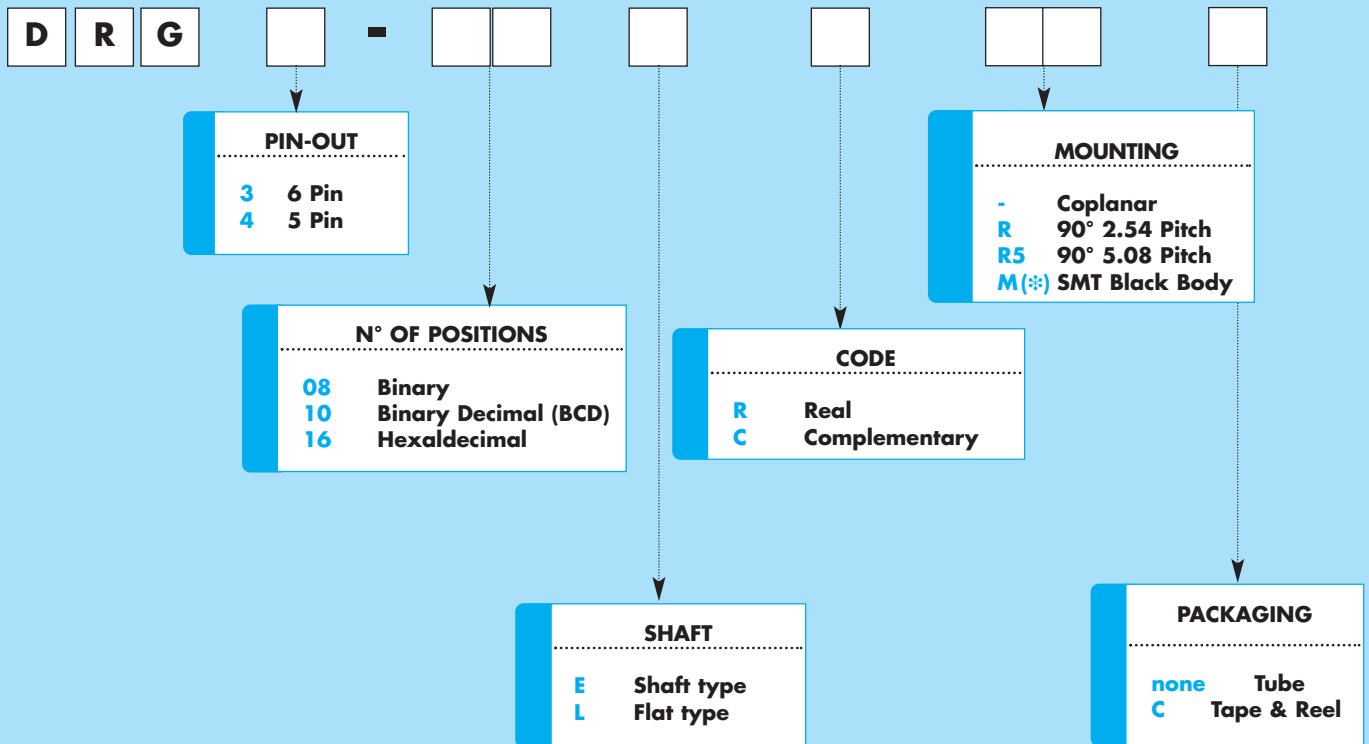

(*) Available only with " 3 " Pin Out option and " L " shaft option - Tape & Reel

SERIES DRG3-4, DRGM

PIN-OUT AND PCB LAYOUT

Right Angle Models

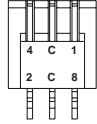

**3
6Pin**

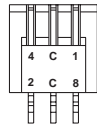

P.C.B. LAYOUT

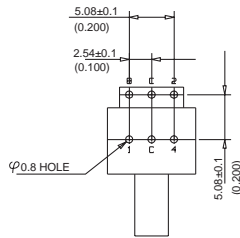
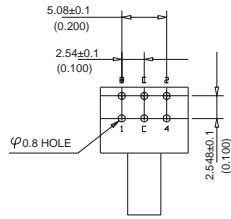

Coplanar Models

Bottom view



Top view

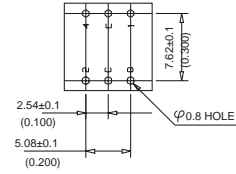

Right Angle Models

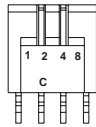

**4
5Pin**

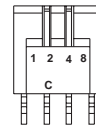

P.C.B. LAYOUT

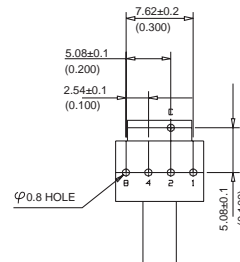
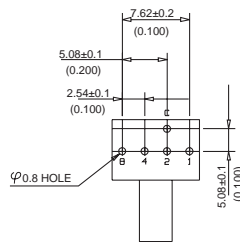

Coplanar Models

Bottom view



Top view

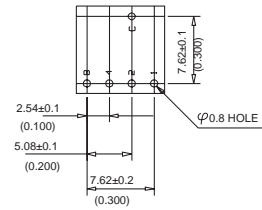

Note: white dot on corner enables to locate switch on PCB

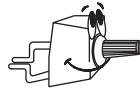

SERIES DRG3-4,DRGM

NUMBER OF POSITIONS

08 Binary
(1 out of 8 Codes)

PIN N°	POSITION							
	0	1	2	3	4	5	6	7
1	○	●	○	●	○	●	○	●
2	○	○	●	●	○	○	●	●
4	○	○	○	○	●	●	●	●
8	○	○	○	○	○	○	○	○

Marked 0 - 7 on the face

10 BCD
(1 out of 10 Codes)

PIN N°	POSITION									
	0	1	2	3	4	5	6	7	8	9
1	○	●	○	●	○	●	○	●	○	●
2	○	○	●	●	○	○	●	●	○	○
4	○	○	○	○	●	●	●	●	○	○
8	○	○	○	○	○	○	○	○	●	●

Marked 0 - 9 on the face

16 Hexadecimal
(1 out of 16 Codes)

PIN N°	POSITION															
	0	1	2	3	4	5	6	7	8	9	A	B	C	D	E	F
1	○	●	○	●	○	●	○	●	○	●	○	●	○	●	○	●
2	○	○	●	●	○	○	●	●	○	○	●	●	○	○	●	●
4	○	○	○	○	●	●	●	●	○	○	○	○	●	●	●	●
8	○	○	○	○	○	○	○	○	○	○	○	○	○	○	○	○

Marked 0 - 9, A, B, C, E, F on the face

Colour Coding for Rotors

	Real Code ○		Complementary Code ●	
Pin - out Rotor Colour	6 Pin White	5 Pin Yellow	6 Pin Red	5 Pin Orange

SERIES DRG3-4, DRGM

SHAFT MOUNTING AND DIMENSIONS

DRG3

DRG4

L
Without Shaft
Coplanar

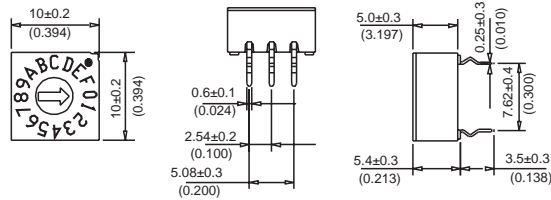

Part N° shown: DRG3-16LR

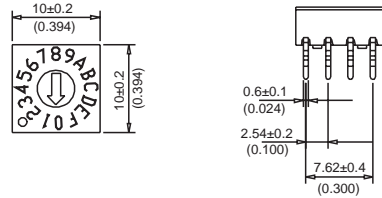

Part N° shown: DRG4-16LR

E
With Shaft
Coplanar

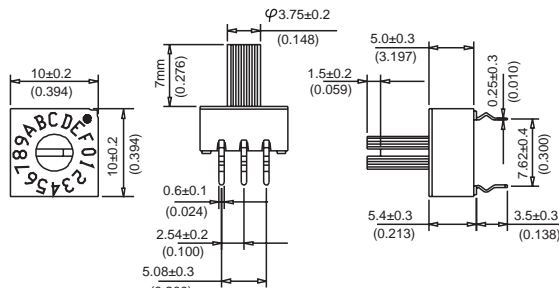

Part N° shown: DRG3-16ER

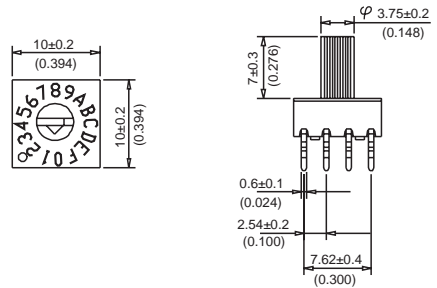

Part N° shown: DRG4-16ER

L - R
Without Shaft
90° 2.54 mm pitch

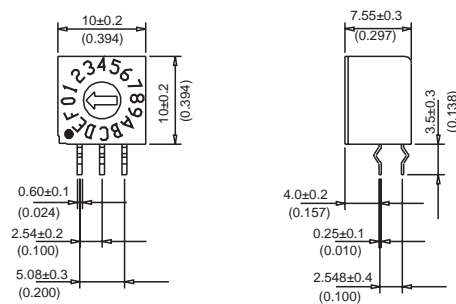

Part N° shown: DRG3-16LRR

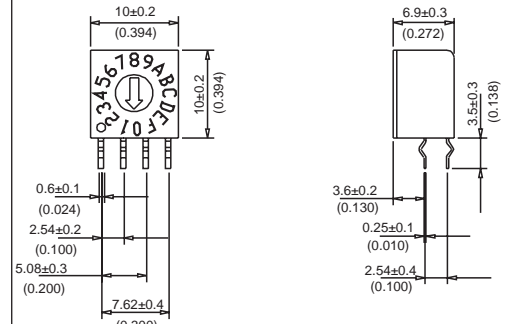

Part N° shown: DRG4-16LRR

E - R
With Shaft
90° 2.54 mm pitch

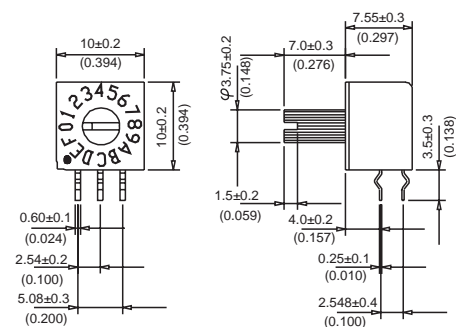

Part N° shown: DRG3-16ERR

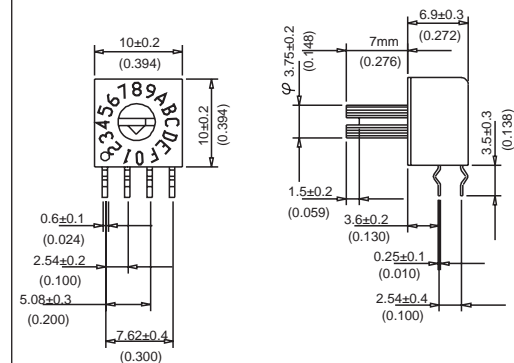

Part N° shown: DRG4-16ERR

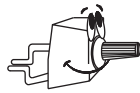

SERIES DRG3-4, DRGM

SHAFT MOUNTING AND DIMENSIONS

DRG3

L - R5
Without Shaft
90° 5.08 mm pitch

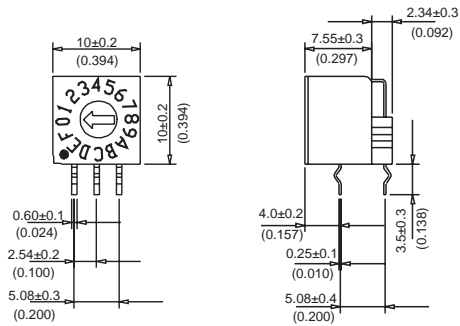

Part N° shown: DRG3-16LRR5

DRG4

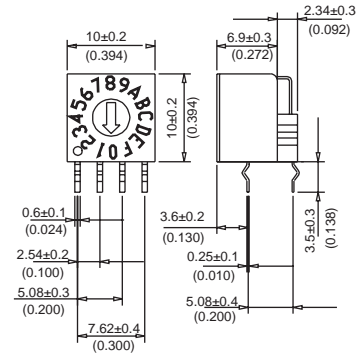

Part N° shown: DRG4-16LRR5

E - R5
With Shaft
90° 7mm
(0.276) pitch

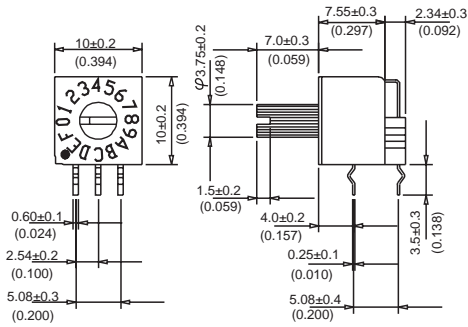

Part N° shown: DRG3-16ERR5

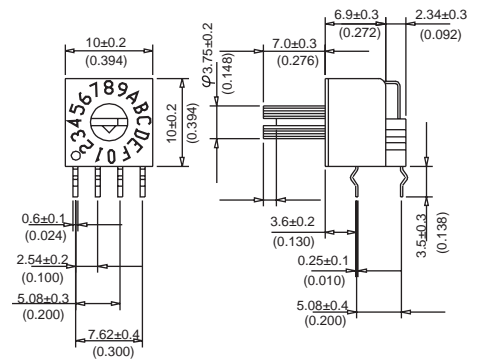

Part N° shown: DRG4-16ERR5

Bottom view

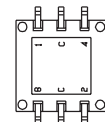

Top view

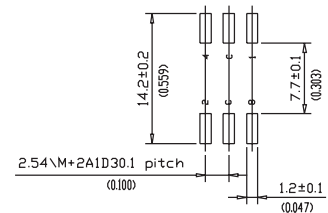

3 - L - M
(Surface Mount) SMT

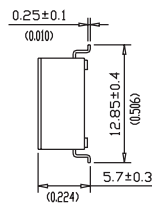
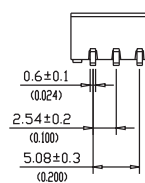
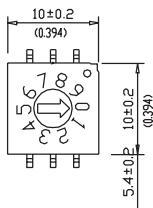

Part N° shown: DRG-308 LRMC

SERIES DRG3-4, DRGM

SHAFT INDEXING CAP

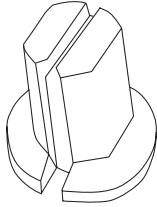

CAP	PIN OUT	CODE	
118-80100	3	R/C	White
118-80300	4	R/C	Yellow
118-80200	3	C/C	Red
118-80400	4	C/C	Orange

R/C: Real Code
C/C: Complementary Code

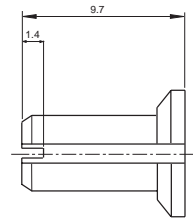
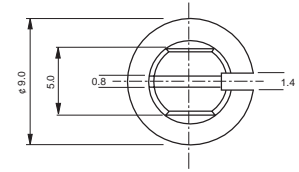

The indexing caps can be added to all **E** option shaft and allow easy reading of indexing position

PACKAGING

Tube: 50 pcs/Tube

Tape & Reel: 700 pcs for reel

LABELLING (on packaging)

The label tray gives full information on the products contained.

P/N: EL.FNC.: Q.TY: DATE CODE:  Made in Taiwan	
Remarks	

A Bar code indicating Model, Quantity, Date Code enables easy traceability.

