

MANUAL INSERTION (Vertical Mount)

SERIES EDQE

- Vertical Bracket
- 12x12 mm size
- Square Stem

E D Q E -

CAP + COLOURS OPTIONS

Caps
EDSC-21-x Square
EDSC-22-x Round

Colours
K Black
R Red

Height from PCB (h)

E 6.45 mm

Operating Force Life (Cycles)

1	100±50gf	1×10 ⁶
2	160±50gf	5×10 ⁴
3	260±70gf	3×10 ⁴

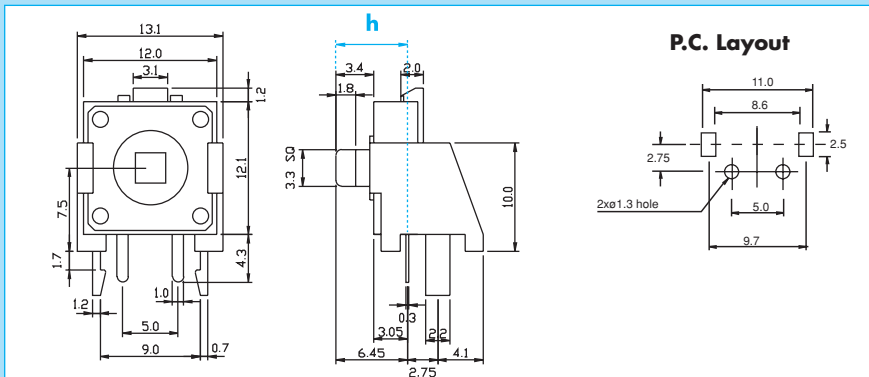

SPECIFICATIONS

Rating: 50mA - 12VDC
Contact resistance: 100 mΩ max
Bounce: 5msec max
Return force: 40 gf min

PACKAGING

Qty: 500/Bag
Type of packaging: Loose

- Vertical Bracket
- 12x12 mm size
- Grooved Stem

E D Q F -

Height from PCB (h)

F 11.20 mm

Operating Force Life (Cycles)

1	100±50gf	1×10 ⁵
2	160±50gf	5×10 ⁴
3	260±70gf	3×10 ⁴

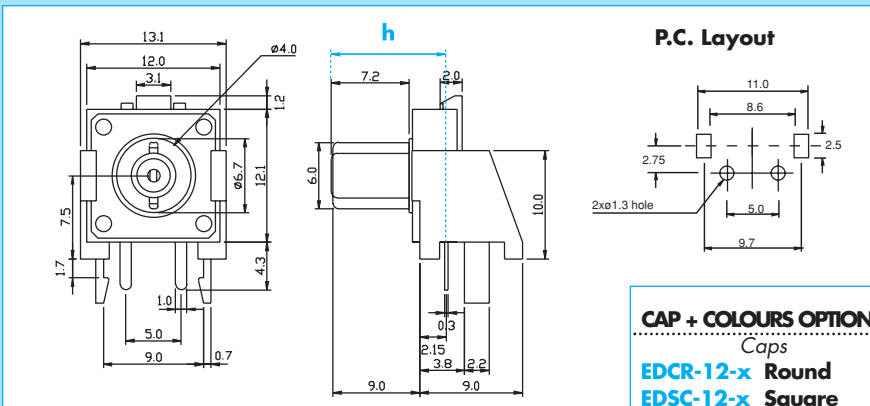

SPECIFICATIONS

Rating: 50mA - 12VDC
Contact resistance: 100 mΩ max
Bounce: 5msec max
Return force: 40 gf min

PACKAGING

Qty: 500/Bag
Type of packaging: Loose