

SERIES KB



CHARACTERISTICS

- Small 6x6 mm Base
- Lighted and not lighted
- Round and square caps
- Available w/o Cap
- Only 8.2 mm High

SPECIFICATIONS

Rating: Switching 50 mA @ 12VDC max
Contact Resistance: 100 mΩ max initial
Insulation Resistance: 100 MΩ min @ 500V
Temperature: Operating -10°C to +60°C
Operating Life: 100.000 operations
Operating Force: 250±50 gf

PACKAGING

Type of Packaging: Tray

HOW TO ORDER

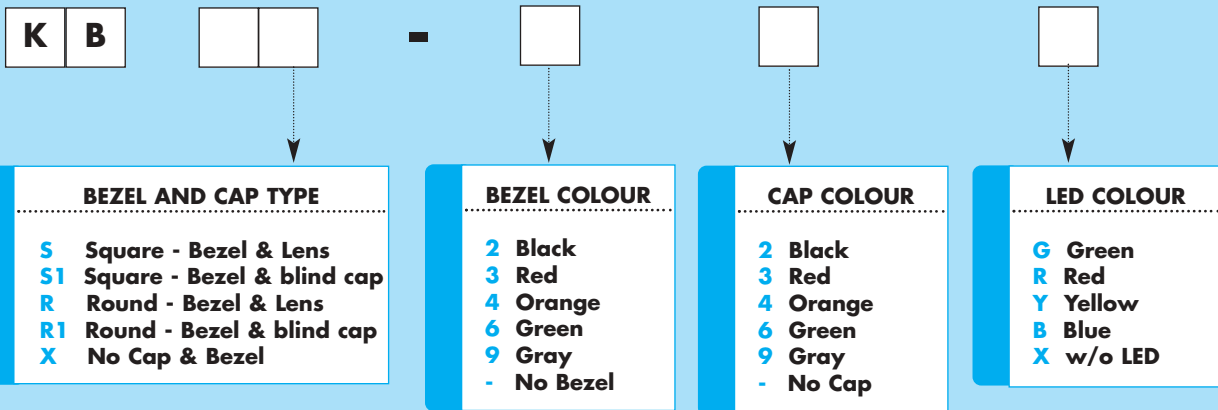

DIMENSIONS

X
Type

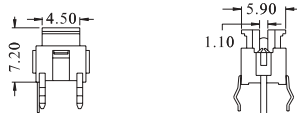

Part N° shown: KBX-x
(define x)

R
Type

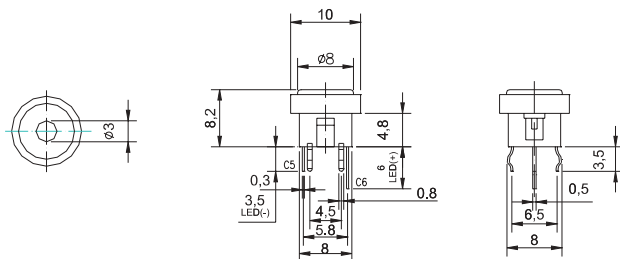

Part N° shown: KBR-xxx
(define xx)

P.C.B. Layout

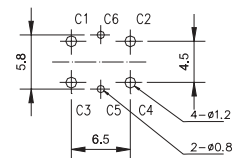

Circuit Diagram

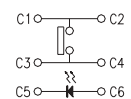

S
Type

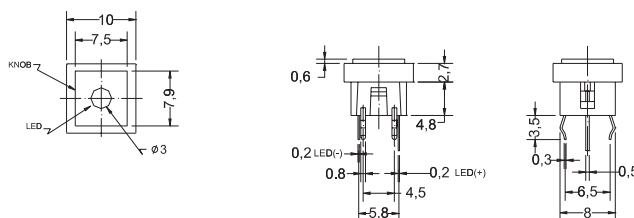

Part N° shown: KBS-xxx
(define xx)