



SERIES KS TH1

- **Miniature Key-Lock Switch**
- **200 Key Codes**

CHARACTERISTICS

- Tubular Key
- 200 combinations
- 4 Pin Tumbler Mechanism

SPECIFICATIONS

Contact Rating: 1A @ 125 VAC or 28 VDC - 0,5A @ 250 VAC
Contact Resistance: <10 m Ω
Insulation Resistance: 10° Ω min.
Dielectric Strength: 1000 V RMS Min @ sea level
Electric Life: 6.000 make & break cycles @ full load

MATERIALS

Lock Housing: Zinc alloy Die-cast
Cylinder: 4 Disk tumbler in Zinc alloy tubular keys, chrome plated
Keys: Zinc alloy, chrome plated
Contacts: Silver plated
Terminals: Silver plated

HOW TO ORDER

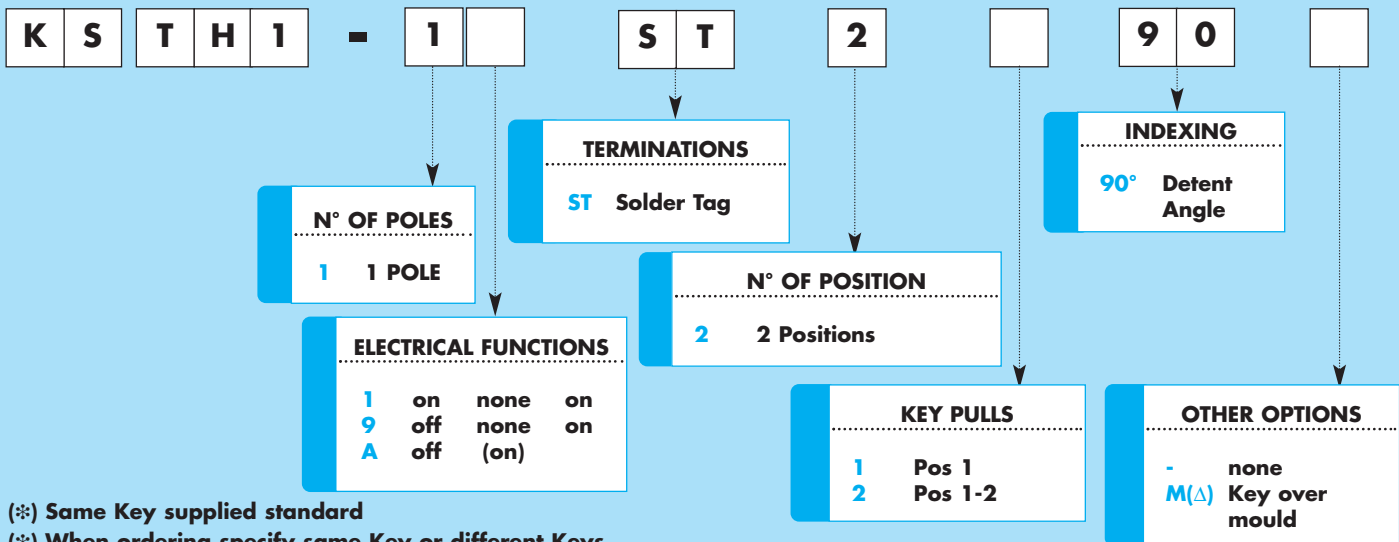

(*) Same Key supplied standard
 (*) When ordering specify same Key or different Keys
 Min Qty per lot apply for different Keys - Please enquire -

(Δ) Min qty required

Over - Mould option

Models Available Table:

MODELS AVAILABLE	SYMBOL	KEY PULL
KS TH1-19ST2190		Pos 1
KS TH1-19ST2290		Pos 1-2
KS TH1-11ST2190		Pos 1
KS TH1-11ST2290		Pos 1-2
KS TH1-1AST2190		Pos 1

LEGEND

- off
- on
- △ mom
- no key pull
- key pull

Dimensions and Views:

- Top view: 19,5 x 32,7 mm
- Key Code: ****
- Key Code: A (90°), B
- Thread: M12x1
- Dimensions: 15, 4, 14, 25,5, 30,5, 10,5, 15, 10,7, 12
- Views: (ON-ON), (OFF-ON)

KEY-LOCK SWITCHES

SERIES KS TH2

- Miniature ON-OFF Key-Lock Switch
- Short body

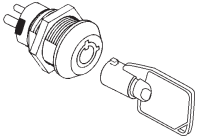

CHARACTERISTICS

- Short body
- Tubular Key
- 200 combinations
- 4 Pin Tumbler Mechanism

SPECIFICATIONS

Contact Rating: 1A @ 125 VAC or 28 VDC - 0,5A @ 250 VAC
Contact Resistance: <10 mΩ
Insulation Resistance: 10⁷ Ω min.
Dielectric Strength: 1000 V RMS Min @ sea level
Electric Life: 6.000 make & break cycles @ full load

MATERIALS

Lock Housing: Zinc alloy Die-cast
Cylinder: Zinc alloy Die-cast
Keys: Bright chrome plated
Contacts: Silver plated
Terminals: Silver Plated

HOW TO ORDER

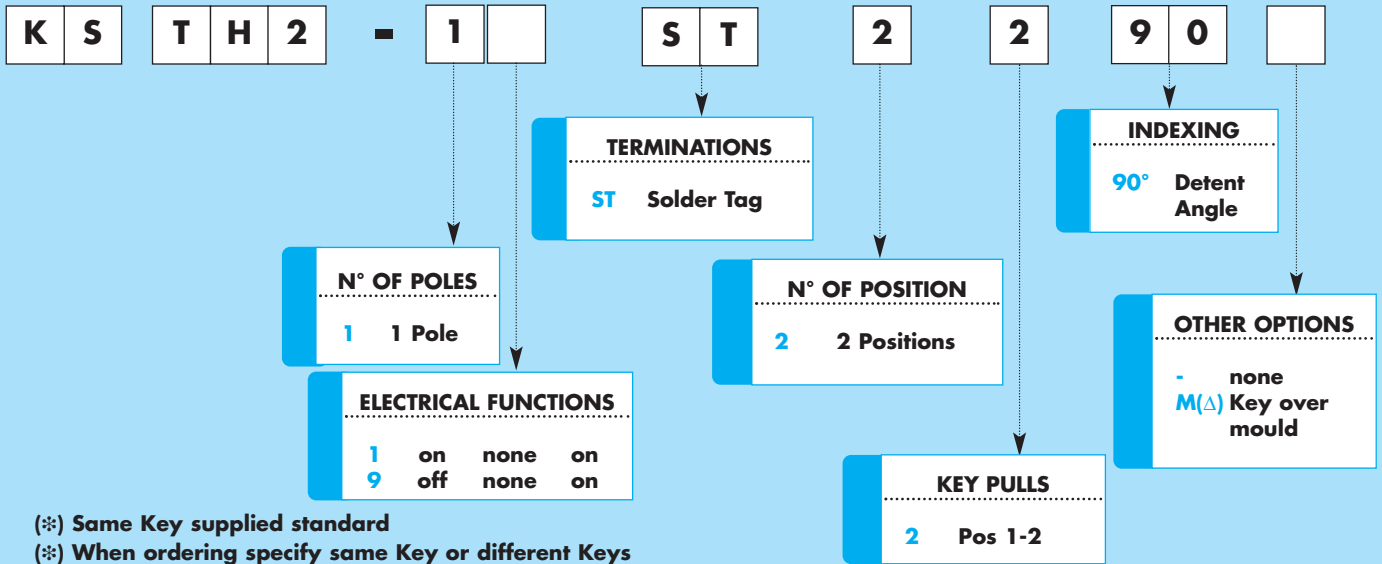

(Δ) Min qty required

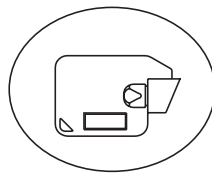

Over - Mould option

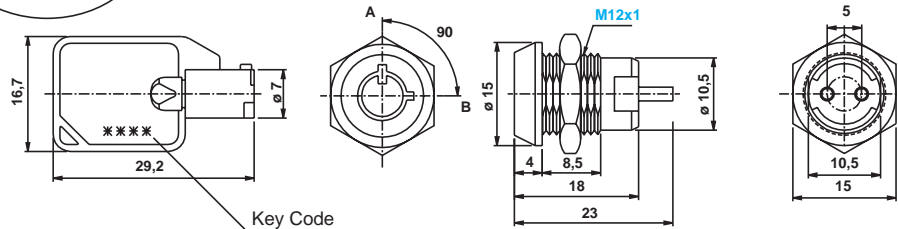

MODELS AVAILABLE SYMBOL KEY PULL

KS TH2-11ST2290		Pos 1-2
KS TH2-19ST2290		Pos 1-2

LEGEND

—	off	—	no key pull
●	on	○	key pull
△	mom		

