

SERIES RTA

Ultra-miniature Rotary Switch



CHARACTERISTICS

- 9.2 mm Dia
- Clear Indexing
- PCB Mounting

SPECIFICATIONS

Rating: Switching 0.5A @ 24VDC max
Contact Resistance: 50 mΩ max initial
Insulation Resistance: 100 MΩ min @ 100V
Temperature: Operating -20°C to +65°C
Operating Life: 2.500 operations
Operating Torque: 1.4 - 4 kg/cm initial

HOW TO ORDER

R T A

□ □ □

POLE / POSITIONS

- 102** 1P 2 Pos
- 103** 1P 3 Pos
- 104** 1P 4 Pos
- 105** 1P 5 Pos
- 106** 1P 6 Pos
- 107** 1P 8 Pos (std)

DIMENSIONS

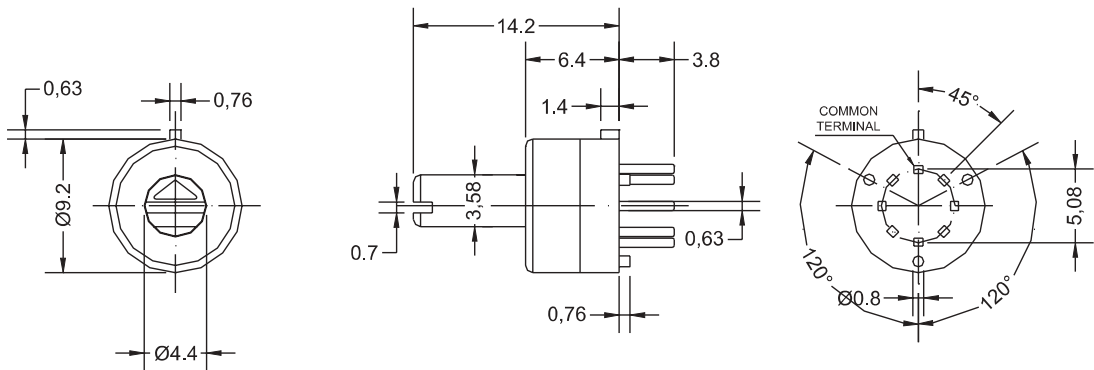

Part N° shown: RTA107

P.C.B. layout

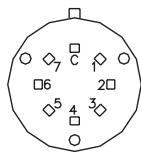

Schematic

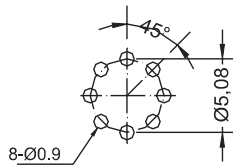

TRAVEL	SWITCHING POSITION
45°	1
90°	2
135°	3
180°	4
225°	5
270°	6
315°	7