

SERIES SG

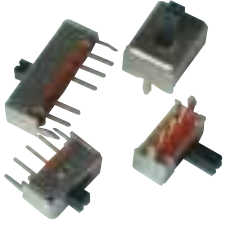

CHARACTERISTICS

- Miniature Slide switches
- Contact-wipe Action
- 1, 2 and 4 Poles
- Straight and Side actuated
- 2 mm Terminal spacing

SPECIFICATIONS

Rating: 100 mA max @ 12VDC
Contact Resistance: 20 mΩ max initial
Insulation Resistance: 100 MΩ min @ 500V
Temperature: Operating -10°C to +60°C
Operating Life: 10,000 operations
Operating Force: 300±150 gf
Soldering specifications: 240°C for 3 Secs
Contacts: Silver plated

HOW TO ORDER

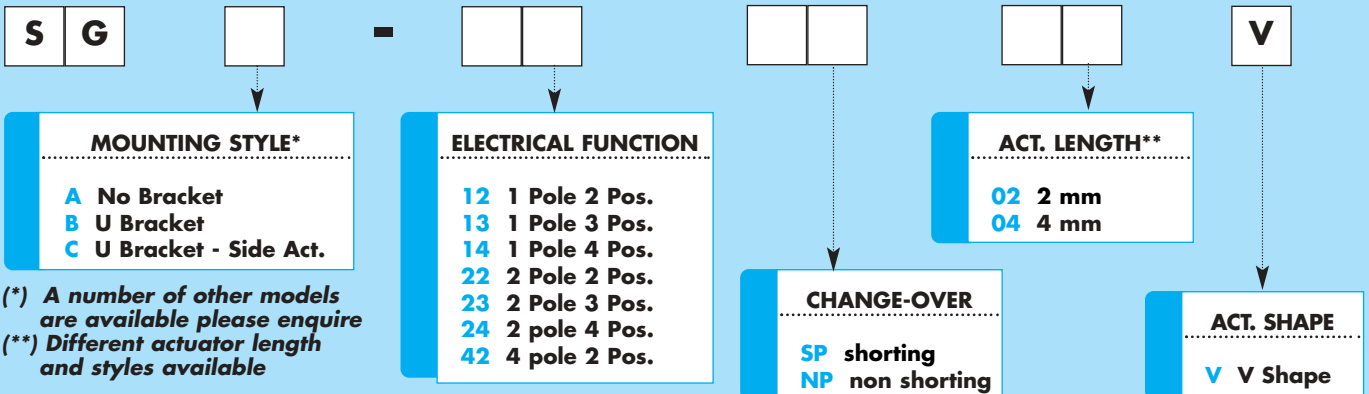

MOUNTING STYLE

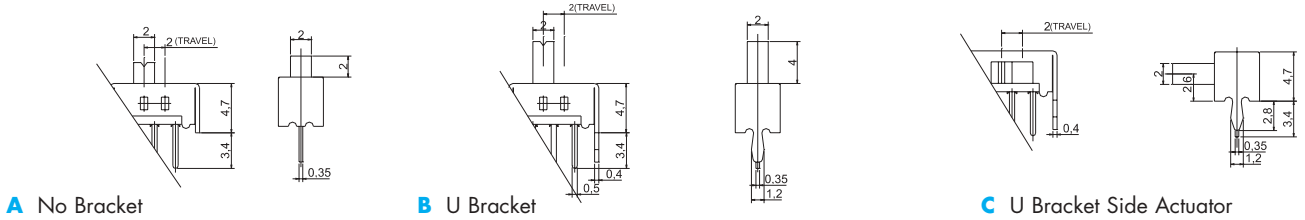

DIMENSIONS

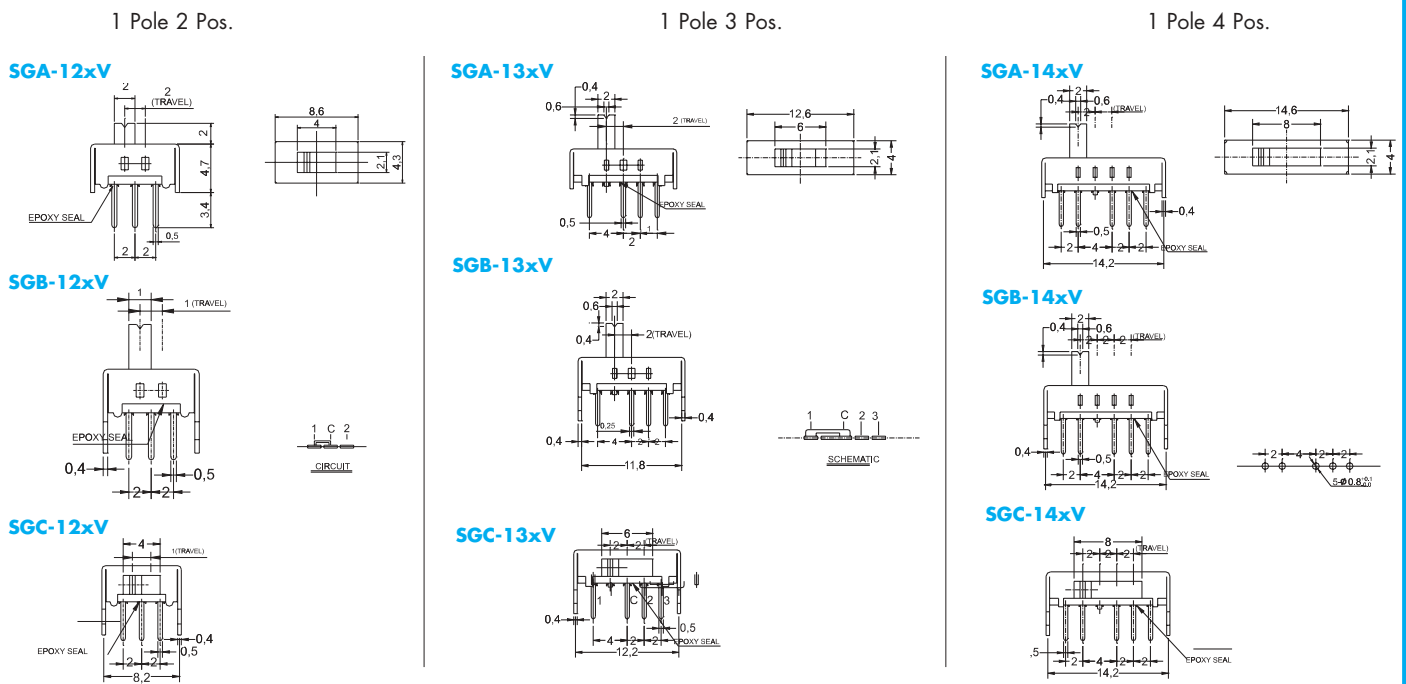

DIMENSIONS

2 Pole 2 Pos.

SGA-22xV

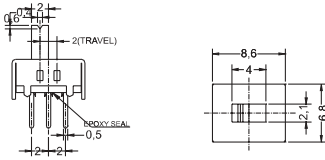

SGB-22xV

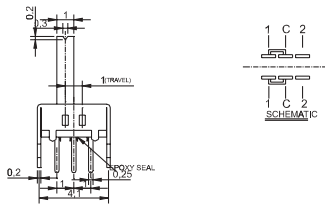

SGC-22xV

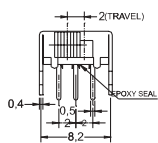

2 Pole 3 Pos.

SGA-23xV

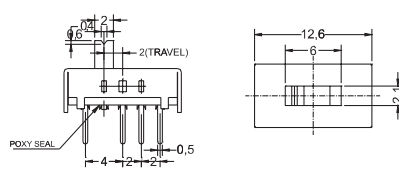

SGB-23xV

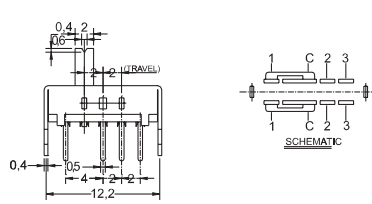

SGC-23xV

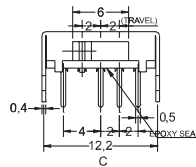

2 Pole 4 Pos.

SGA-24xV

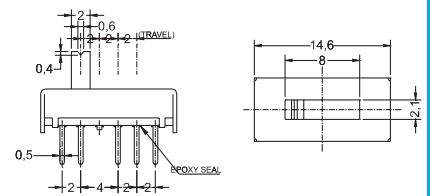

SGA-24xV

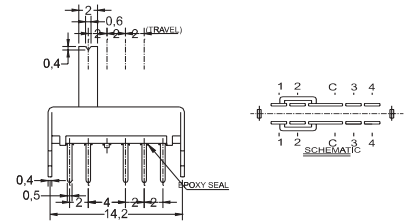

SGC-24xV

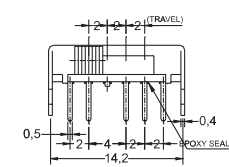

4 Pole 2 Pos.

SGA-42xV

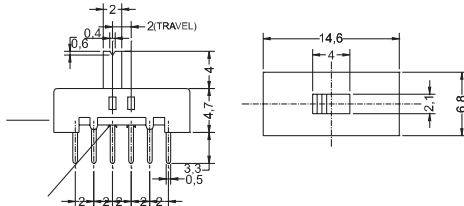

SGB-42xV

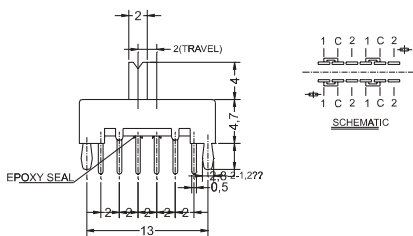

SGC-42xV

